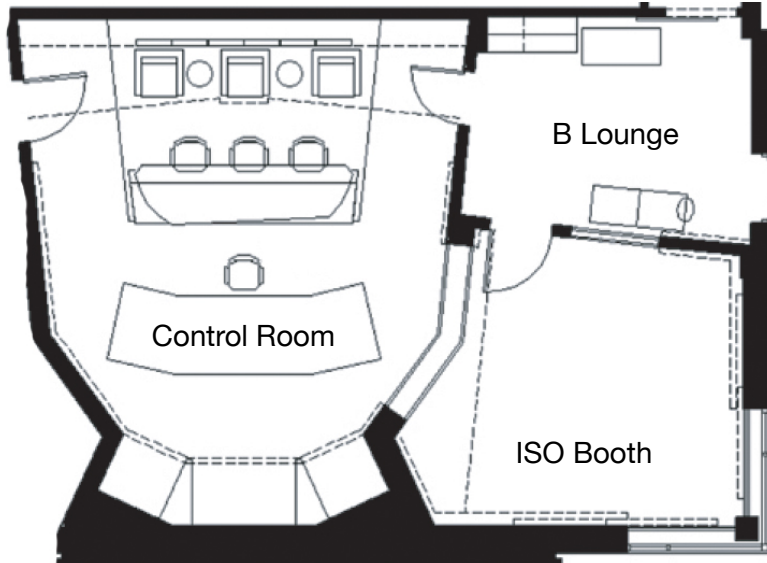

FLOORPLAN

in:ciite | STUDIOS
Studio B Floorplan

OVERVIEW

Studio B is centered around a Avid S6 and 9.1.4 Dolby Atmos Monitoring system featuring Dynaudio Custom M4+ for the L,C,R, AIR15s for the surround and Height Speakers as well as three 18" Custom Dynaudio subwoofer to serve as the LFe. This room has been used for many feature films, television, and music shows.

The studio has a very private feel with its own dedicated lounge. The isolation room is large and has natural lighting. As well as being a great tracking room, Studio B has been one of the most sought after ADR rooms in the Southeast.

STUDIO B EQUIPMENT LIST

CONSOLE / CONTROL SURFACE

- Avid S6 Control Surface
- 24 Faders 3 x (8 Fader Modules)
- Process Module x 3
- Knob Module x 3
- Automation Module
- Joystick Pan Module
- Post Module

PRE AMPS

Universal Audio 2-610 Tube Amplifier (2 ch.) M1 John Hardy's x 4

COMPRESSORS/LIMITERS/GATES

Tube-Tech CL-2A

DIGITAL FX

Yamaha SPX-900 Multi-Effects Processor

• MONITORING

(Dolby tuned & Certified)

- Custom Dynaudio M4+ (L,C,R)
- Custom DynAudio 18-Inch Sub (L,C,R)
- DynAudio "Air 15" Lss, Rss, Lsr, Rsr, Ltf, Rtf, Ltr, Rtr, Lw, Rw)
- Paradigm Active/20 v.2 Nearfield (L,R)

MULTI-TRACK RECORDERS

- MacPro 2019
- 3.2HGz 16 Core Intel Xeon
- 224GB RAM
- W5700x 16GB Radeon GPU
- Avid Sync HD Synchronizer (Clock Master)
- Avid MTRX Interface
- 1 x 8 Analog Line/Mic input Card
- 2 x 8 Analog Output Card
- 1x Digilink Expansion Card (128 PT I/O)
- 1 x Dante I/O Card

PROJECTION SYSTEMS

- 9 ft. Draper Micro-Perf motorized screen
- Optoma UHD60 4K DLP Projector (3000 lumen)

MIXDOWN/PLAY-BACK/LAY-BACK

Xbox Series X (Streaming & UHD Blu-Ray playback)
AppleTV 4k - Apple Music & Tidal (Atmos Playback)

POWER AMPS & CROSSOVERS

XTA Electronics DP224
Digital Programmable/Recallable
Crossover System
DynAudio DCA Series Amplifiers

CUE

- Focusrite RedNET AM2 Dante Headphone Box
- Cue 8 Analog Headphone Box